

# PUSH-BUTTON TEMPERATURE TRANSMITTER

## Programmable, RTD, Thermistor or Thermocouple Input, In-Head Mounting

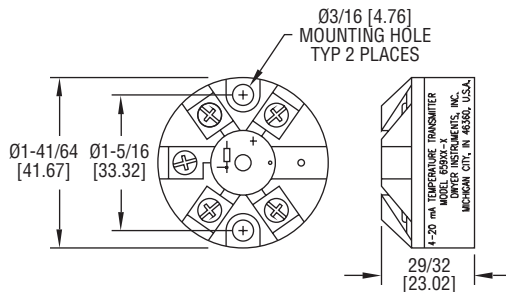

The **SERIES 659** Push-Button Temperature Transmitters accept thermocouple (J, K, T), RTD (Pt100 $\Omega$ ) or thermistor input and provide a linearized 4 to 20 mA output. The transmitter is quickly ranged and calibrated by using a single on-board switch.

### FEATURES/BENEFITS

- Push button calibration adjustment
- Reverse polarity protection
- Standard temperature sensor head enclosure mounting
- Sensor fault LED

### APPLICATIONS

- Process applications where a 4 to 20 mA signal is required

MODEL CHART	
Model	Input
659TC-1	Thermocouple (Type J, K, T)
659RTD-1	3-wire (RTD Pt100)
659TH-1	Thermistor (2252 $\Omega$ )

### SPECIFICATIONS

**Input Range:** Type J T/C: -328 to 2192°F (-200 to 1200°C); Type K T/C: -328 to 2498°F (-200 to 1370°C); Type T T/C: -328 to 752°F (-200 to 400°C); Pt100  $\Omega$  RTD: -328 to 1562°F (-200 to 850°C); Thermistor: -13 to 257°F.

**Accuracy:** T/C models:  $\pm 0.04\%$  FS.,  $\pm 0.04\%$  of reading or  $\pm 0.5^\circ\text{C}$  whichever is greater; RTD:  $\pm 0.2^\circ\text{C} \pm 0.1\%$  of rdg; Thermistor:  $\pm 0.25^\circ\text{F}$  ( $\pm 0.1^\circ\text{C}$ ).

**Output:** Linearized 4 to 20 mA, 2-wire loop powered.

**Sample Rate:** 500 ms.

**Loop Resistance:** T/C: 700  $\Omega$  @ 24 VDC; RTD: 800  $\Omega$  @ 24 VDC; Thermistor: 24 VDC.

**Output Thermal Drift:** Zero:  $0.2\mu\text{A}/^\circ\text{C}$ ; Span:  $0.5\mu\text{A}/^\circ\text{C}$ .

**Temperature Limits: Ambient:** -4 to 158°F (-20 to 70°C), 80% RH max.

**Ambient Storage Temperature:** -40 to 158°F (-40 to 70°C), 95% RH max.

**Burnout:** Upscale 22 mA.

**Weight:** 0.92 oz (26 g).

**Agency Approvals:** CE.