

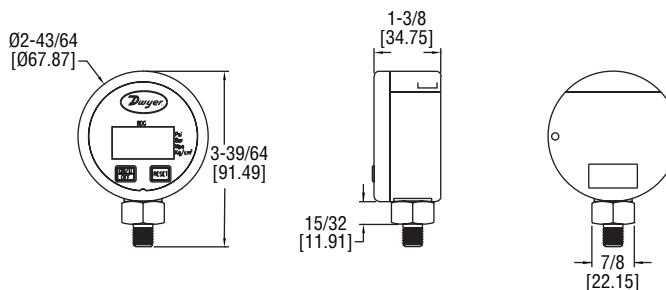

Model BDG Brass Digital Pressure Gage

Specifications - Installation and Operating Instructions



The Model BDG-01 Brass Digital Pressure Gage measures gas pressure with $\pm 0.5\%$ of full-scale accuracy at an affordable price. With brass wetted material, the Model BDG is designed for your specific applications of compatible gasses. Its design allows for easy installation. User-selectable units of measure let one gage be used for various pressure scales.

Location

Select a location where the gage can be easily read and the temperature will not exceed 140°F (60°C). The mounting surface to the gage should be free from excessive vibration.

Installation

When installing the gage, always use $7/8"$ hex wrench at the base of the housing to tighten the gage to a mating fitting. Be sure to use proper thread sealant when installing. Do not apply wrench to housing.

Key Functions

ON/U
OFF - ON/U/OFF (LB) – On/Off/Unit Change

RESET - RESET (RB) – Reset Zero/Backlight

Operation

To turn on the gage, press **ON/U OFF**. This button also allows you to scroll through the units, which are located on the right side of the display. To reset zero, press and hold **RESET** for 2 seconds until display re-zeros. Press and hold **ON/U OFF** for 2 seconds to turn off the gage.

Calibration

To ensure accurate pressure readings, be sure to zero gage before first use. This eliminates readings to any change in atmospheric pressure. Only zero gage while it is disconnected from any fitting. It is also recommended to re-zero the gage once a year.

Battery Removal

If the battery is low, the display will show "Lob" and turn off after 3 seconds. To replace the battery, unscrew the plastic cover on the top of the gage housing. Then remove the battery and replace with a new one. Make sure the (+) and (-) polarities are correct.

SPECIFICATIONS

Service: Compatible gases.

Wetted Materials: Brass and silicone sensor.

Housing Materials: ABS plastic.

Accuracy: $\pm 0.5\%$ FS.

Long Term Stability: $\pm 0.05\%$ FS per year.

Pressure Limits: 2X pressure range; Burst pressure: 3X pressure range.

Enclosure Rating: IP10.

Temperature Limits: 14 to 140°F (-10 to 60°C).

Thermal Effect: $\pm 0.04\%$ FS per $^{\circ}\text{C}$.

Size: 2.5" O.D.

Process Connection: $1/4"$ male NPT.

Display: 4-digit LCD ($1-1/4 \times 5/8"$).

Power Requirements: 3 V CR123A lithium metal battery, installed functional, user replaceable.

Battery Life: 2 to 3 years typ.

Weight: 0.29 lb (0.13 kg).

MAINTENANCE/REPAIR

Upon final installation of the Model BDG no routine maintenance is required. The Model BDG is not field serviceable and should be returned if repair is needed. Field repair should not be attempted and may void warranty.

WARRANTY/RETURN

Refer to "Terms and Conditions of Sales" in our catalog and on our website. Contact customer service to receive a Return Goods Authorization number before shipping the product back for repair. Be sure to include a brief description of the problem plus any additional application notes.